

D I S T I N C T I V E D E T A I L S

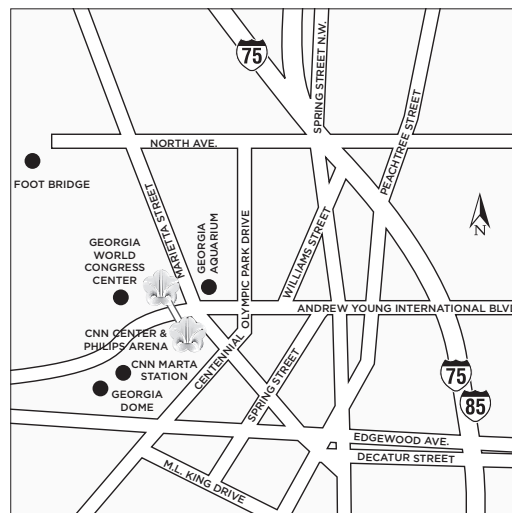

D I R E C T I O N S

From Hartsfield-Jackson International Airport: Follow I75/I85N into downtown Atlanta to exit 248-C (International Boulevard); At second traffic light, turn left onto Andrew Young International Boulevard; Turn left onto Centennial Olympic Park Drive; Turn right onto Marietta Street; Hotel is located on the left.

DESTINATIONS

Offering an unforgettable setting within the bustling CNN World Headquarters, the elegant Omni Hotel at CNN Center opens its doors to all that is Atlanta. Centrally located in the heart of one of the nation's most vibrant cities, this luxury hotel connects you to the world. Enjoy an exquisite menu of local and regional delicacies at the Prime Meridian Restaurant or explore world-renowned sights and attractions, right outside the doorstep. And while this sophisticated hotel is equipped with the most modern amenities, you'll discover a level of hospitality that embodies the warm spirit of the South.

LOCATION

- Located in the heart of downtown Atlanta, within CNN World Headquarters
- Across from Centennial Olympic Park and the closest hotel to the Georgia Dome and the Georgia World Congress Center
- 12 miles/15 minutes from Atlanta Hartsfield-Jackson International Airport
- Located on MARTA rapid transit
- Convenient to Interstates 85 and 75
- Located in the heart of the Luckie Marietta District, Atlanta's newest entertainment hub. The LMD is a one-stop shop with numerous entertainment options, sports venues and a variety of dining choices all within walking distance from the hotel. Area attractions include Centennial Olympic Park, the Georgia Aquarium, the Georgia Dome, Imagine It! The Children's Museum of Atlanta, Inside CNN Studio Tour, National Museum of Patriotism and Philips Arena.
- 1 block to the home of the Coca-Cola museum adjacent to Centennial Olympic Park.
- 1 block to the world's largest aquarium, Georgia Aquarium, a \$200 million marine museum
- 10 blocks to the Fox Theatre, a National Historic Landmark theatre featuring mosque-style architecture and host to world-renowned live performances such as the "Phantom of the Opera" and "Les Miserables"
- 10 minutes to the High Museum of Art, a large gallery space featuring a permanent collection of 19th and 20th century American art, as well as temporary exhibits on loan from the Louvre
- 10 minutes to the Atlanta Botanical Garden, home of the Fuqua Conservatory, featuring an array of rare and endangered tropical and desert plants
- 10 minutes to the Martin Luther King, Jr. History Center, a four-block region commemorating Dr. King's birthplace, residence, place of worship and burial site
- A short drive to Zoo Atlanta, located in historic Grant Park, featuring rare and exotic animals, like the giant panda, in their natural habitat
- A short drive to Stone Mountain, Lake Lanier and the Atlanta Motor Speedway
- A short drive to Six Flags Over Atlanta, an exciting amusement park for the whole family with roller coasters, shows and special events

ATTRACTIONS

- Adjacent to Philips Arena, the Georgia Dome and the Georgia World Congress Center, one of the largest sporting, entertainment and convention complexes in the world
- Located within CNN World Headquarters, home of CNN News and CNN Headline News. Experience world news live at the Inside CNN Studio Tour. Also home to the Braves Clubhouse Store, the Turner Store and more
- Situated within the bustling CNN Center Complex are a wide variety of dining options from McCormick & Schmick's Seafood Restaurant to Don Juan Mexican Restaurant, Dantanna's and a large selection of fast food restaurants
- Across the street from Centennial Olympic Park, a 30-acre park honoring the 1996 Olympic Games and featuring the dramatic Olympic Fountain of Rings

TEMPERATURE

Month	High	Low	Average
January	52	33	43
February	56	36	46
March	64	43	54
April	73	51	62
May	80	59	70
June	86	67	77
July	89	70	80
August	88	69	79
September	82	64	73
October	73	53	63
November	63	42	53
December	54	36	45

Atlanta enjoys a mild year-round climate, with highs in the upper 80s during the summer months and lows just above freezing in the wintertime.

TRANSPORTATION

- Atlanta Hartsfield-Jackson International Airport is a 15-minute drive from the hotel
- 24-hour airport shuttle and taxi service available
- MARTA rapid transit provides bus and rail service throughout Atlanta

GUEST SERVICES

GUEST SERVICES

- Concierge service
- Full-service business center
- 24-hour guest room dining
- Gift shop, newsstand and beauty salon located within the hotel
- Banking, postal services, fast food restaurants and shops located within CNN Center
- Same-day dry cleaning and laundry service
- Shoe shine services available
- Wheelchair access, Braille signage and in-room strobe fire alarms

In-Room Technology

- Large work desks with two dual-line telephones, dataports and voice mail
- WebTV
- Wireless Internet access available

In-Room Amenities

- Twice-daily housekeeping (upon request)
- Evening turndown service available
- Coffee maker and complimentary coffee
- Iron and full-size ironing board
- Triple sheeting on beds
- Foam or feather down pillows available upon request
- Complimentary *USA Today* delivered to your room each morning

OMNI SENSATIONAL KIDS' PROGRAM

- A list of top family attractions located near the hotel available at the concierge desk
- Rolling backpacks for kids to take to their room, filled with puzzles, games and books to read at bedtime
- Complimentary backpack-style bag with kid-friendly sensory items presented at check-in

- Colorful kid's cup with unlimited refills to use throughout their hotel stay
- Kid-themed menu in the restaurant
- Milk and cookies on night of arrival

BUSINESS CENTER

Located in the executive office of the South Tower, our full-service business center is complete with computers in a private environment. Guests may ship and receive all business-related materials from the Business Center. Most services are available Monday through Friday during regular business hours. For business services during evenings and weekends, please contact the Front Desk. Services include:

- Photocopying and fax machine
- Free-standing computer terminals with high-speed Internet access
- Secretarial and notary public services
- Color transparency services
- General office supplies available for purchase
- Video/data monitors and overhead projectors
- VCR/DVD and camera rental

VIP GIFTS

Our staff is well-versed in the selection of special amenities for VIP guests and would be happy to make customized arrangements prior to your guest's arrival. You may also purchase an Omni Hotels gift certificate, a luxurious gift for those who appreciate first-class service. For more information, contact the Front Desk or visit omnihotels.com

RECREATION

- Located on the 6th floor of the North Tower, the Natural Body Spa at the Omni Hotel at CNN Center is committed to the true meaning of spa, *Sanitas per Agua*, and focuses on healing through water. Whether you have 20 minutes or 2 hours, we have a way to help you relax and rejuvenate. Spa services include: facials, massages, body treatments, nail services, waxing and sanctorum, a sound spa experience. To book an appointment for services, please call our concierge to arrange an appointment.
- The Get Fit Kit also enables guests to work out in the privacy of their own room. This complimentary kit includes a floor mat, free weights, portable radio with earphones, elastic stretch bands and an informative exercise booklet. The Get Fit Kit is available at the Front Desk to use during your stay.
- The North Tower features an outdoor swimming pool, a state-of-the-art fitness center with flat screen TVs, and massage and spa treatment rooms.

OFF-SITE RECREATION

- Off-site golf within a 15-minute drive from the hotel (reserved through concierge)
- Running and walking trails in and around Centennial Olympic Park
- Jogging maps are available through the concierge

ACCOMMODATIONS

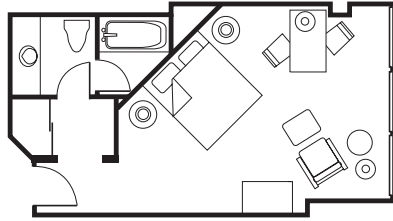

DELUXE KING

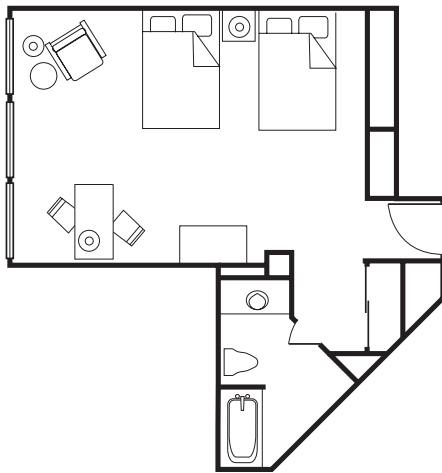

DELUXE DOUBLE/DOUBLE

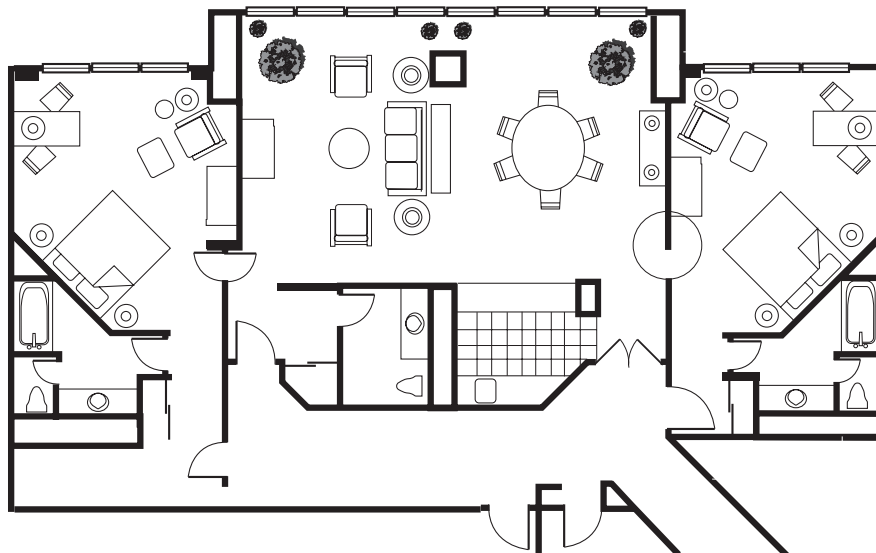

DELUXE SUITE

GUEST ROOMS

Discover an atmosphere of unparalleled sophistication and elegant style within our 1,070 spacious guest rooms and suites. Each beautifully appointed room offers magnificent views of the downtown skyline or the lively CNN Center Atrium. Here you will find all the comforts for the 21st century traveler, including wireless Internet access, two dual-line telephones with dataports, voice mail and an oversized work desk, as well as luxuries like exquisite crown molding, marble floors and Chinese granite countertops in all baths.

SUITES

Relax among exquisite appointments and beautiful furnishings in one of our 32 luxury suites, all accented by dark woods and elegant crown molding. For the ultimate experience, escape to our bi-level, three-room suite, an oasis of luxury and sophistication with high-tech amenities and a deluxe marble bath area with a grand Jacuzzi tub.

ACCOMMODATIONS

GUEST ROOM INVENTORY

Room Category	Number of Guest Rooms			Square Ft.	Special Features
	South Tower	North Tower	Total		
Deluxe Double/Double	241	377	618	392	Beautifully appointed rooms with oversized work desks, two dual-line telephones and elegant decor
Deluxe King	216	204	420	364	Luxury rooms with modern amenities, beautiful appointments and spacious marble baths
Junior Suite	1	—	1	728	Oversized luxury suite with dark woods, beautiful appointments and three dual-line telephones
Omni Suite	1	—	1	2,324	Bi-level, three-bedroom suite overlooking CNN Atrium and featuring a grand Jacuzzi bath
Sarge Suite	1	—	1	1,120	Spacious and elegant suite featuring a large sitting area and a dining area that's ideal for entertaining guests, one connecting bedroom overlooking the lively CNN Center
Capital Suite	1	—	1	728	Deluxe suite with a private balcony offering a panoramic view and elegant décor featuring traditional furnishings and dark woods
Phoenix Suite	1	—	1	728	Deluxe suite with a private balcony offering a panoramic view and elegant décor featuring traditional furnishings and dark woods
Presidential Suite	—	1	1	2,044	Spacious and elegant suite featuring large living room, a separate conference room, two bedrooms with king-size beds and windows overlooking beautiful Centennial Olympic Park
VIP Suite	—	9	9	728	Magnificently decorated suites offering large living rooms with sleeper sofas in a private setting, perfect for hospitality events
Governor's Suite	—	1	1	1,120	Luxury suite featuring a full kitchenette, wet bar, separate dining room, marble foyer entry and other luxury appointments
Parlor Suite	8	—	8	728	One- to three-room suites accommodating up to 50 guests with parlors, dining tables for 4-8 people, a wet bar and full kitchenette
Hospitality Suites	—	8	8	728	One- to three-room suites accommodating up to 50 guests with parlors, dining tables for 4-8 people, a wet bar and full kitchenette
Total	470	600	1,070		

All guest rooms are equipped with an iron and ironing board, hair dryer, coffee maker, terry bathrobes, wireless Internet access, large work desk, two dual-line telephones, dataports and voice mail. Additionally, all guest rooms in the North Tower feature CD/radio alarm clocks and an in-room safe.

FOOD & BEVERAGE

Prime Meridian

Renowned for its outstanding location and magnificent city views, Prime Meridian offers exceptional cuisine in an elegant atmosphere. Our executive chefs will prepare an unforgettable meal using the most unique local and regional ingredients with low-calorie and heart-healthy options. Available for private events. Seats 144.

Parallels Private Dining Room seats 24.

Hours of operation Monday - Sunday:

Breakfast: 6:30 a.m. - 11:00 a.m.

Lunch: 11:30 a.m. - 2:30 p.m.

Dinner: 5:00 p.m. - 10:30 p.m.

Latitudes Bistro & Lounge

One of Atlanta's most sophisticated gathering places for specialty drinks and appetizers. Seats 86.

Hours of operation Monday - Saturday:

Lunch: 11:30 a.m. - 5:30 p.m.

Dinner: 5:30 p.m. - 1:00 a.m.

Sunday:

Lunch: 1:00 p.m. - 5:30 p.m.

Dinner: 5:30 p.m. - 12:00 a.m.

Morsel's

Help yourself to Morsel's, a self-serve coffee shop offering freshly brewed Starbucks coffee, specialty coffee drinks, delicious pastries, cookies, soups, sandwiches and other refreshments.

Hours of operation Monday - Sunday:

6:00 a.m. - 10:00 p.m.

Please contact the concierge for more information.

The Overlook

Located off the main lobby with floor-to-ceiling windows overlooking the Centennial Olympic Park, the Overlook is ideal for enjoying a specialty cocktail with a spectacular view of the Atlanta skyline.

Guest Room Dining

24-hour guest room dining is available if you choose to enjoy delicious cuisine in the privacy of your guest room.

CONFERENCE SPECIFICATIONS

CONFERENCE AND BANQUET

The comfort and convenience of our meeting space allow for a flexible and stress-free event, even for the most technologically demanding presentations. In addition, our highly trained staff will gladly assist you in making your event a memorable one.

The Omni Hotel at CNN Center features more than 120,000 square feet of premier meeting, pre-function and exhibit space. Catering services for all hotel events are provided by the Omni Hotel at CNN Center. Off-site catering is also available for events located directly adjacent to the hotel, within Centennial Olympic Park and other designated locations. Ask your Catering Manager for more details.

South Tower

- The Atrium Terrace, a contemporary 15-story glass-enclosed atrium, encompasses more than 12,000 square feet of multi-use function space. This elegant space is surrounded by guest room towers and CNN Center office towers, and overlooks the CNN Center floor. Highlights include elegant Italian marble floors, tenting capabilities and sweeping views of the world-famous CNN Center. The Atrium Terrace Level is perfect for private events of up to 2,588 guests and can also accommodate up to 88, 8' x 10' exhibits or 73, 10' x 10' exhibits on the entire terrace level. Guests may also hold private functions within six fully enclosed meeting rooms located along the perimeter of the Atrium Terrace Level.
- The 1,400 square-foot Club Lounge, on the 15th floor, is the perfect setting for meetings, retreats, hospitality events and receptions. The Club Lounge features ergonomic leather chairs, separate living room alcove, private restroom, entertainment center and floor-to-ceiling windows overlooking the CNN Center floor.

- The Overlook is ideal for lunches, dinners and cocktails in a relaxed setting. It features 15-foot floor-to-ceiling windows with panoramic views of downtown and Centennial Olympic Park.
- Just off the lobby, the Oak and Cedar meeting rooms offer the perfect setting for presentations, training, board meetings or private dining. The rooms adjoin via double doors, which can be opened to create a total of 1,776 square feet of flexible space.
- The 15,000 square-foot Exhibit Hall, just off the Motor Lobby, offers ample space for 85, 10' x 10' or 115, 8' x 10' booths. This state-of-the-art facility features electrical and Ethernet outlets, built-in concession areas, stage areas and street-side drive-in loading dock.

North Tower

- For business or social events, choose either the beautiful 14,196 square-foot International Ballroom or the elegant 19,864 square-foot Grand Ballroom, with floor-to-ceiling windows overlooking Centennial Olympic Park.
- 16 additional break-out rooms are available for events of any size.
- Both the International and Grand Ballroom levels can accommodate a total of up to 250, 8' x 10' or 200, 10' x 10' exhibits.
- The 596 square-foot Willow Boardroom, located near the Grand Ballroom, features a 14-seat boardroom table with ergonomic leather chairs and a plasma screen TV.

BANNER ADVERTISING

- Make a strong impact during citywide conventions with a highly visible banner display.
- Choose from our many exterior and interior wall locations around the hotel and CNN Center complex.

TECHNICAL ASSISTANCE

On-site technicians are available to assist with providing state-of-the-art audio visual equipment and services. This property has a dedicated 100Mbps network solution available for the convenient and reliable use of our customers. A fiber optic backbone and a switched Ethernet network support this state-of-the-art wired infrastructure. Our network supports all operating platforms that use the TCP/IP protocol standards and can handle the most demanding advanced networking applications and requirements.

Electrical Outlets

Electrical outlets are equipped with a modem/fax hookup and are located in all guest rooms and meeting rooms.

Shipping and Receiving

Arrangements are available through the Business Center for your shipping and receiving needs.

Receiving Docks

Your Convention Services Manager can assist in providing special arrangements for delivery of your meeting materials.

Maintenance

Our engineering department is available 24 hours to provide general technical and equipment repair assistance.

Parking

- Covered valet parking (fee)
- Nearby self-parking (open lot)
- Nearby bus and van parking

CONFERENCE SPECIFICATIONS

South Tower
Lower Lobby Level

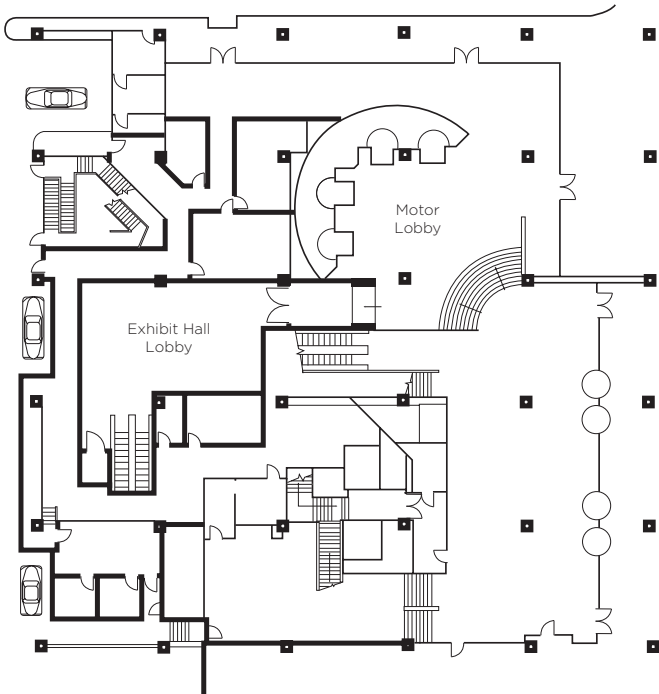

Exhibit Hall

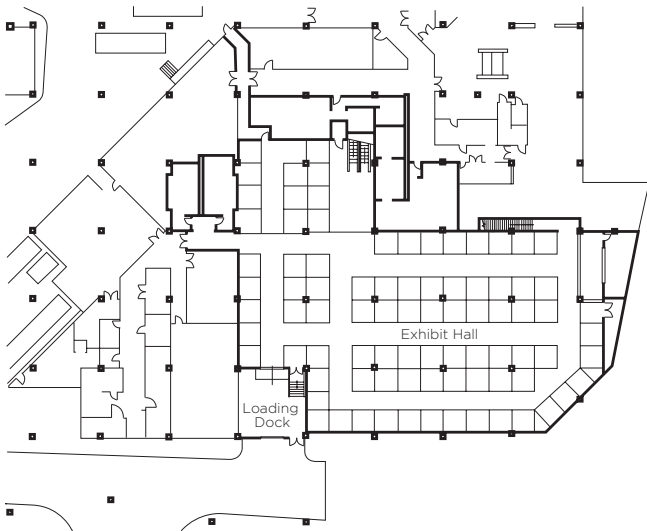
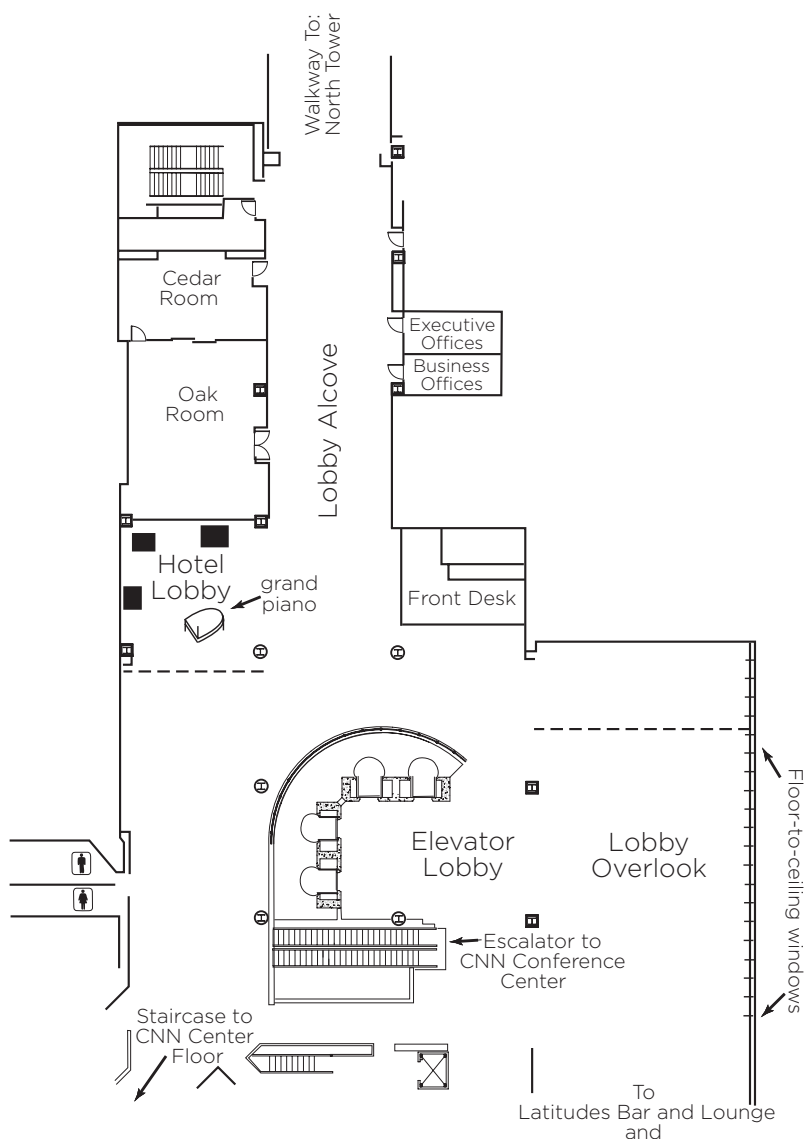

Exhibit Hall Specifications

Room	Square Footage	Dimensions L x W	Ceiling Height	Portable Walls	Theater	Banquet	Reception	Exhibit	
Exhibit Hall	15,000	Irregular	12'	No	1,500	1,200	1,500	115	85

CONFERENCE SPECIFICATIONS

South Tower Hotel Lobby Level



Lobby Level and Penthouse Specifications

Room	Floor	Square Footage	Dimensions L x W	Ceiling Height	Theater	Classroom		Banquet		Reception	Hollow Square
Lobby Overlook	L	-	43' x 55'	15'	-	-	-	-	100	200	-
Cedar Room	L	576	32' x 18'	8'	60	20	12	36	40	55	20
Oak Room	L	1,200	30' x 40'	14'	125	75	50	72	90	120	40

Meeting room capacities are determined by use of the "Arranger & Comfort Calculator," a standardized meeting room capacity measurement system used by Meeting Professionals International. 60" banquet capacities are based on 8 persons per table. 72" banquet capacities are based on 10 persons per table.

CONFERENCE SPECIFICATIONS

South Tower Atrium Terrace Level

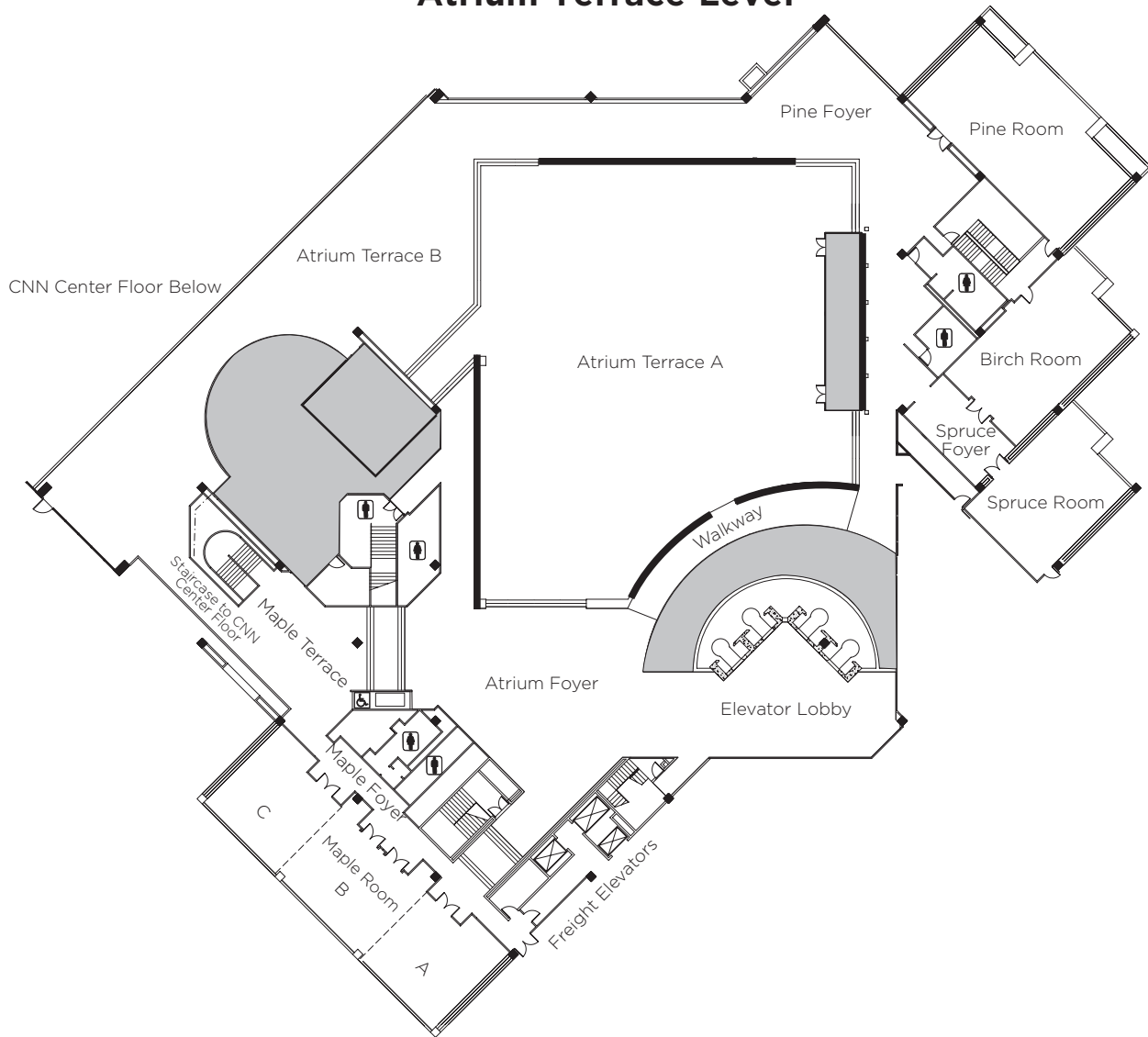

Atrium Terrace Level Specifications

Room	Square Footage	Dimensions L x W	Ceiling Height	Portable Walls	Theater	Classroom 18"	Banquet 72"	Reception	Hollow Square	Exhibit 8'x10' 10'x10'	
Atrium Terrace	12,000	-	15 Stories	No	1,150	575	960	1,262	-	72	60
Atrium Terrace A	10,080	105' x 96'	15 Stories	No	1,000	525	720	1,105	-	60	50
Atrium Terrace B	2,000	-	15 Stories	No	150	50	240	221	-	12	10
Atrium Foyer	3,305	-	15 Stories	No	-	-	130	200	-	16	13
Maple Room	2,200	88' x 25'	10'	Yes	210	120	180	210	-	-	-
Maple Room A	725	29' x 25'	10'	Yes	70	40	60	70	18	-	-
Maple Room B	750	30' x 25'	10'	Yes	70	40	60	70	18	-	-
Maple Room C	725	29' x 25'	10'	Yes	70	40	60	70	18	-	-
Maple Terrace	1,200	-	10'	No	-	-	50	120	-	-	-
Pine Room	1,596	57' x 28'	8'9"	No	160	100	130	160	45	-	-
Pine Foyer	1,300	-	15 Stories	No	-	-	70	120	-	-	-
Birch Room	1,080	27' x 40'	8'9"	No	122	70	90	116	30	-	-
Spruce Room	1,036	37' x 28'	8'9"	No	110	60	80	110	26	-	-
Spruce Foyer	560	28' x 20'	10'	No	-	-	-	50	-	-	-

Meeting room capacities are determined by use of the "Arranger & Comfort Calculator," a standardized meeting room capacity measurement system used by Meeting Professionals International. 60" banquet capacities are based on 8 persons per table. 72" banquet capacities are based on 10 persons per table.

CONFERENCE SPECIFICATIONS

North Tower M1/Street Level

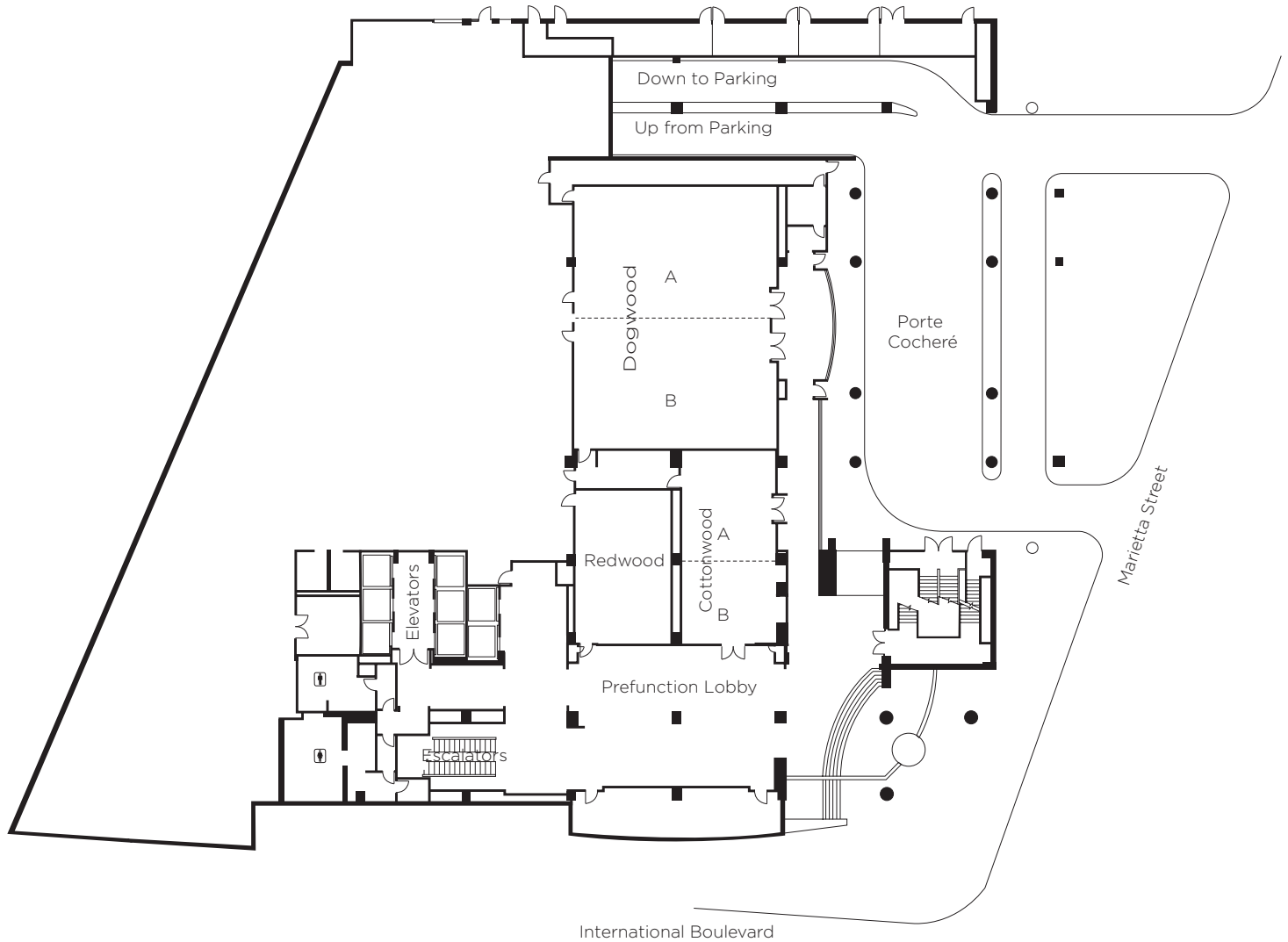

M1/Street Level Specifications

Room	Square Footage	Dimensions L x W	Ceiling Height	Portable Walls	Theater	Classroom		Banquet		Reception	Hollow Square	Exhibit	
						18"	30"	60"	72"			8'x10'	10'x10'
Dogwood	3,547	49'9" x 69'6"	11'6"	Yes	400	246	204	288	290	375	94	22	18
Dogwood A	1,955	49'9" x 38'5"	11'6"	Yes	222	138	114	160	160	211	52	12	10
Dogwood B	1,592	49'9" x 31'1"	11'6"	Yes	177	108	90	128	130	162	42	10	8
Prefunction	2,850	-	-	No	-	-	-	-	-	300	-	-	-
Cottonwood	1,243	24'5" x 50'7"	11'	Yes	138	84	69	96	100	130	30	-	-
Cottonwood A	611	24'5" x 24'5"	11'	Yes	66	39	33	48	50	63	14	-	-
Cottonwood B	632	24'5" x 25'3"	11'	Yes	72	45	36	48	50	68	16	-	-
Redwood	997	24'9" x 39'6"	11'	No	111	69	57	80	80	105	24	-	-

Meeting room capacities are determined by use of the "Arranger & Comfort Calculator," a standardized meeting room capacity measurement system used by Meeting Professionals International. 60" banquet capacities are based on 8 persons per table. 72" banquet capacities are based on 10 persons per table.

CONFERENCE SPECIFICATIONS

North Tower M2/International Ballroom Level

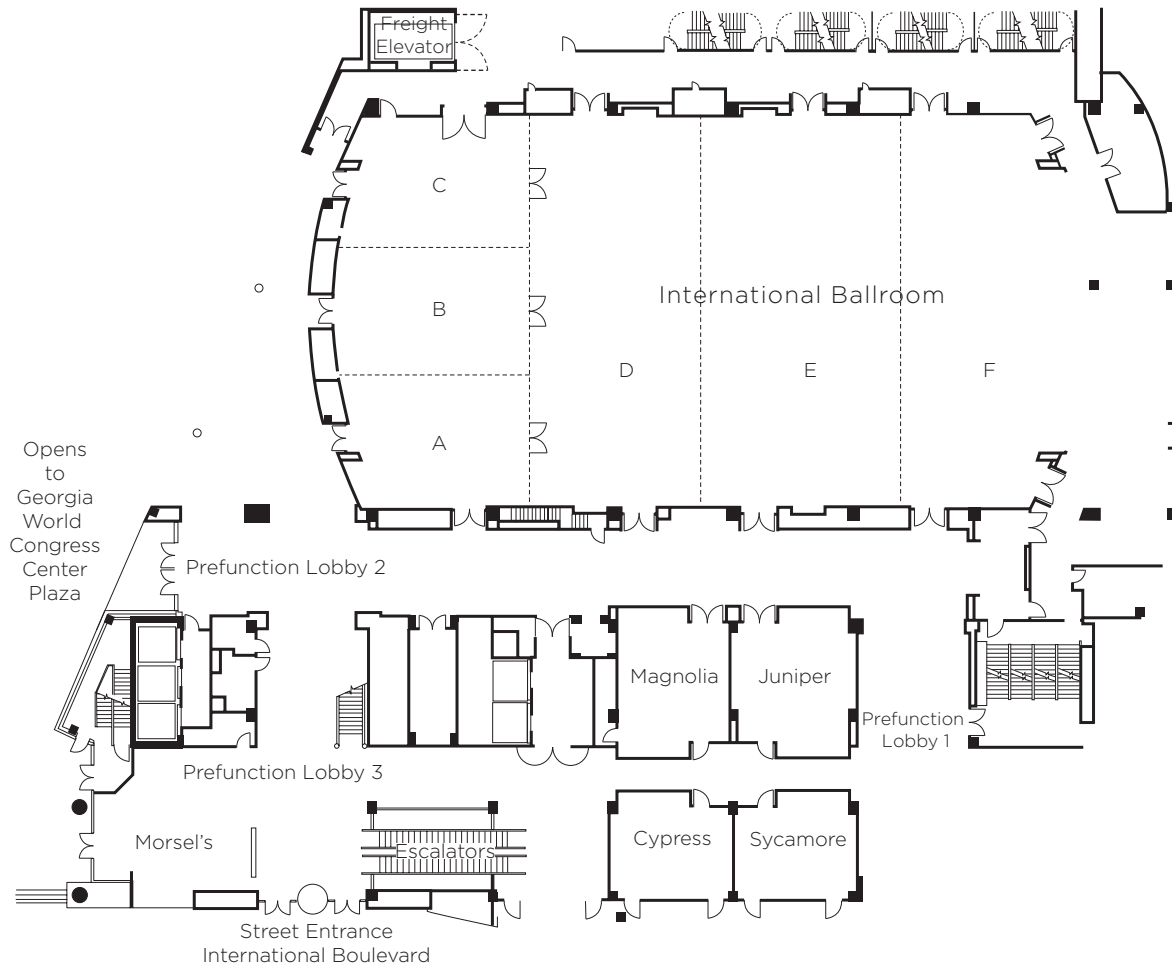

M2/International Ballroom Level Specifications

Room	Square Footage	Dimensions L x W	Ceiling Height	Portable Walls	Theater	Classroom		Banquet		Reception	Hollow Square	Exhibit	
						18"	30"	60"	72"			8'x10'	10'x10'
International Ballroom	14,196	163' x 87'	18'	Yes	1,580	978	810	1,168	1,170	1,500	-	110	82
International Ballroom A	1,181	36'4" x 29'3"	18'	Yes	133	81	69	96	100	126	32	4	3
International Ballroom B	1,226	42' x 28'8"	18'	Yes	138	84	69	104	100	132	34	4	3
International Ballroom C	1,187	36'4" x 29'3"	18'	Yes	133	81	69	96	100	126	32	4	3
International Ballroom D	3,320	38' x 87'2"	18'	Yes	366	228	189	272	270	347	-	20	16
International Ballroom E	3,320	38' x 87'2"	18'	Yes	366	228	189	272	270	347	-	20	16
International Ballroom F	3,962	38'9" x 87'2"	18'	Yes	444	276	228	328	330	421	-	25	20
Prefunction Lobby 2	5,200	-	-	No	-	-	-	-	-	525	-	10	5
Prefunction Lobby 3	1,674	-	-	No	-	-	-	-	-	175	-	-	-
Prefunction Lobby 1	1,540	-	-	No	-	-	-	-	-	160	-	4	4
Juniper	774	24'9" x 26'8"	10'6"	No	88	54	45	64	60	84	18	-	-
Cypress	623	27'6" x 21'2"	10'6"	No	66	39	33	48	50	63	14	-	-
Sycamore	623	27'6" x 21'2"	10'6"	No	66	39	33	48	50	63	14	-	-
Magnolia	814	26'7" x 26'8"	10'6"	No	88	54	45	64	60	84	18	-	-

Meeting room capacities are determined by use of the "Arranger & Comfort Calculator," a standardized meeting room capacity measurement system used by Meeting Professionals International. 60" banquet capacities are based on 8 persons per table. 72" banquet capacities are based on 10 persons per table.

CONFERENCE SPECIFICATIONS

North Tower M3/Meeting Level

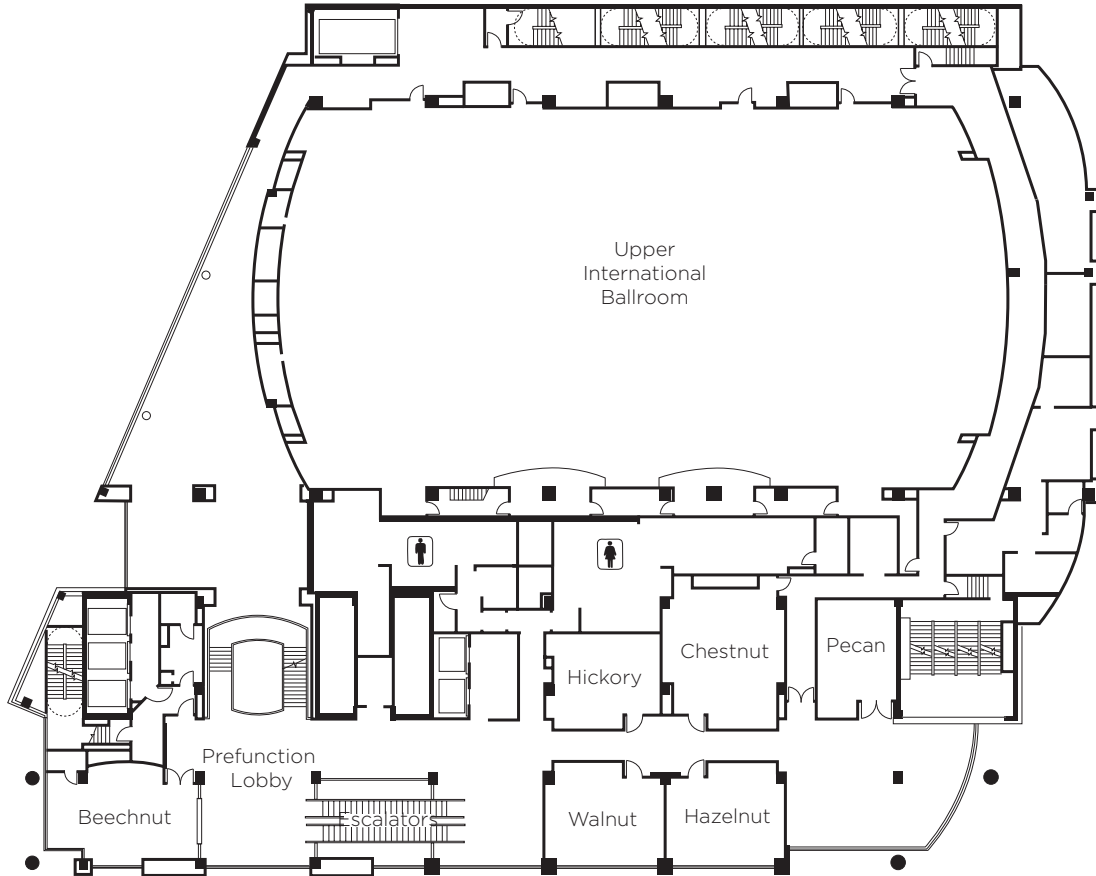

M3/Meeting Level Specifications

Room	Square Footage	Dimensions L x W	Ceiling Height	Theater	Classroom 18" 30"	Banquet 60" 72"	Reception	Hollow Square	Exhibit 8'x10' 10'x10'
Prefunction Lobby	3,840	-	-	-	-	-	405	-	-
Walnut	737	28'5" x 28'1"	10'6"	83	51 42	56 60	79	18	-
Hickory	734	35'10" x 19'6"	10'6"	83	51 42	56 60	79	18	-
Chestnut	624	24'8" x 18'4"	10'6"	66	39 33	48 50	63	14	-
Hazelnut	624	27'6" x 21'2"	10'6"	66	39 33	48 50	63	14	-
Beechnut	512	27'6" x 21'2"	10'6"	55	33 27	40 40	53	14	-
Pecan	472	18'2" x 23'3"	10'6"	55	33 27	40 40	53	14	-

Meeting room capacities are determined by use of the "Arranger & Comfort Calculator," a standardized meeting room capacity measurement system used by Meeting Professionals International. 60" banquet capacities are based on 8 persons per table. 72" banquet capacities are based on 10 persons per table.

CONFERENCE SPECIFICATIONS

North Tower M4/Grand Ballroom Level

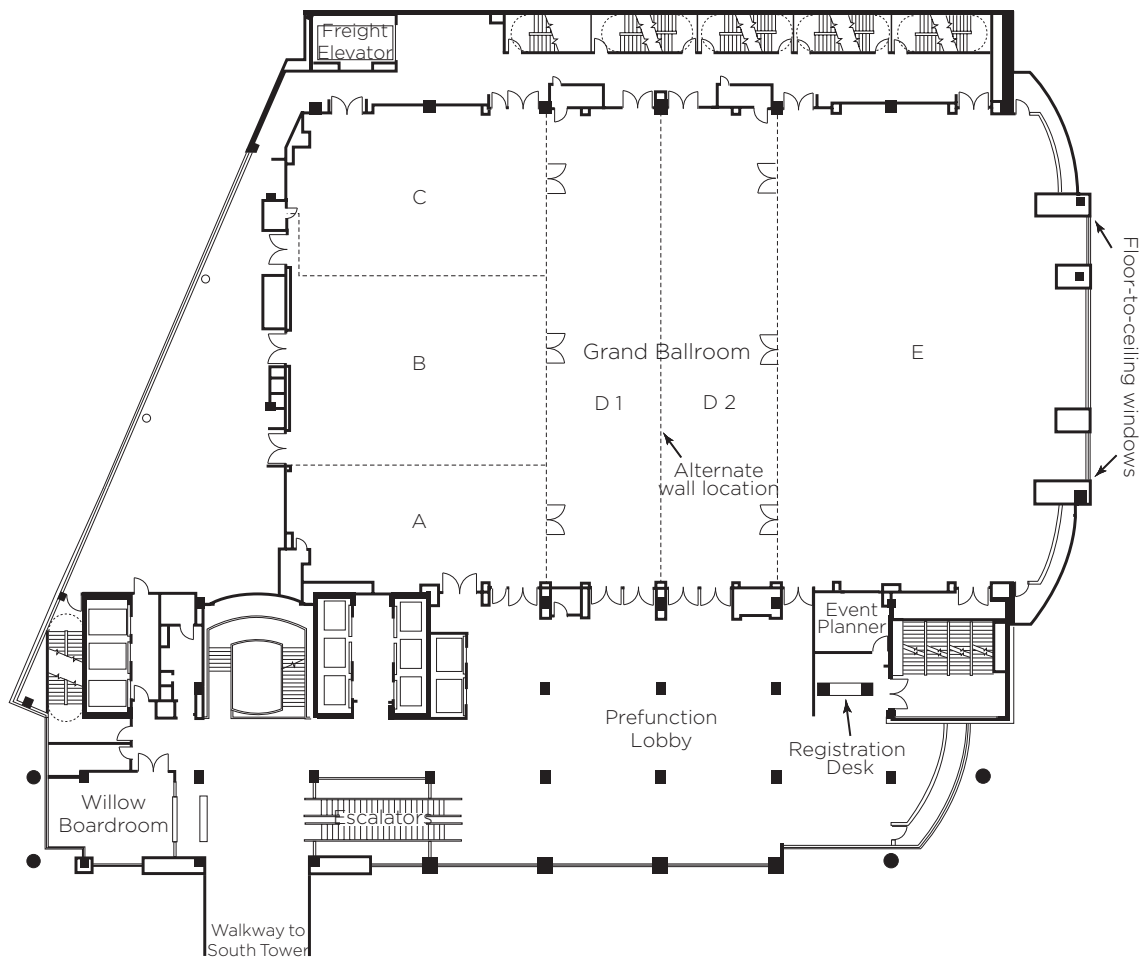

M4/Grand Ballroom Level Specifications

Room	Square Footage	Dimensions L x W	Ceiling Height	Portable Walls	Theater	Classroom		Banquet		Reception	Hollow Square	Exhibit	
						18"	30"	60"	72"			8'x10'	10'x10'
Grand Ballroom	19,864	184' x 108'	21'	Yes	2,212	1,340	1,148	1,656	1,660	2,218	-	124	100
Grand Ballroom A	2,233	57'10" x 37'9"	21'	Yes	225	159	128	184	190	243	60	14	11
Grand Ballroom B	1,940	57'10" x 33'9"	21'	Yes	222	138	114	160	160	211	52	12	10
Grand Ballroom C	2,238	57'10" x 37'9"	21'	Yes	244	150	126	176	180	232	60	13	11
Grand Ballroom D	5,963	54' x 108'10"	21'	Yes	677	420	348	504	500	642	-	38	30
Grand Ballroom D1	2,982	27' x 109'2"	21'	Yes	338	210	174	252	250	321	-	19	15
Grand Ballroom D2	2,982	27' x 109'2"	21'	Yes	338	210	174	252	250	321	-	19	15
Grand Ballroom E	7,490	63'10" x 108'10"	21'	Yes	844	522	432	632	630	800	-	47	38
Prefunction Lobby	6,444	-	-	No	-	-	-	-	-	-	-	20	21
Willow Boardroom	596	30'11" x 16'10"	15'	No	-	-	-	-	-	-	14	-	-

Meeting room capacities are determined by use of the "Arranger & Comfort Calculator," a standardized meeting room capacity measurement system used by Meeting Professionals International. 60" banquet capacities are based on 8 persons per table. 72" banquet capacities are based on 10 persons per table.

CONFERENCE SPECIFICATIONS

North Tower N6/Fitness Center/Pool Level

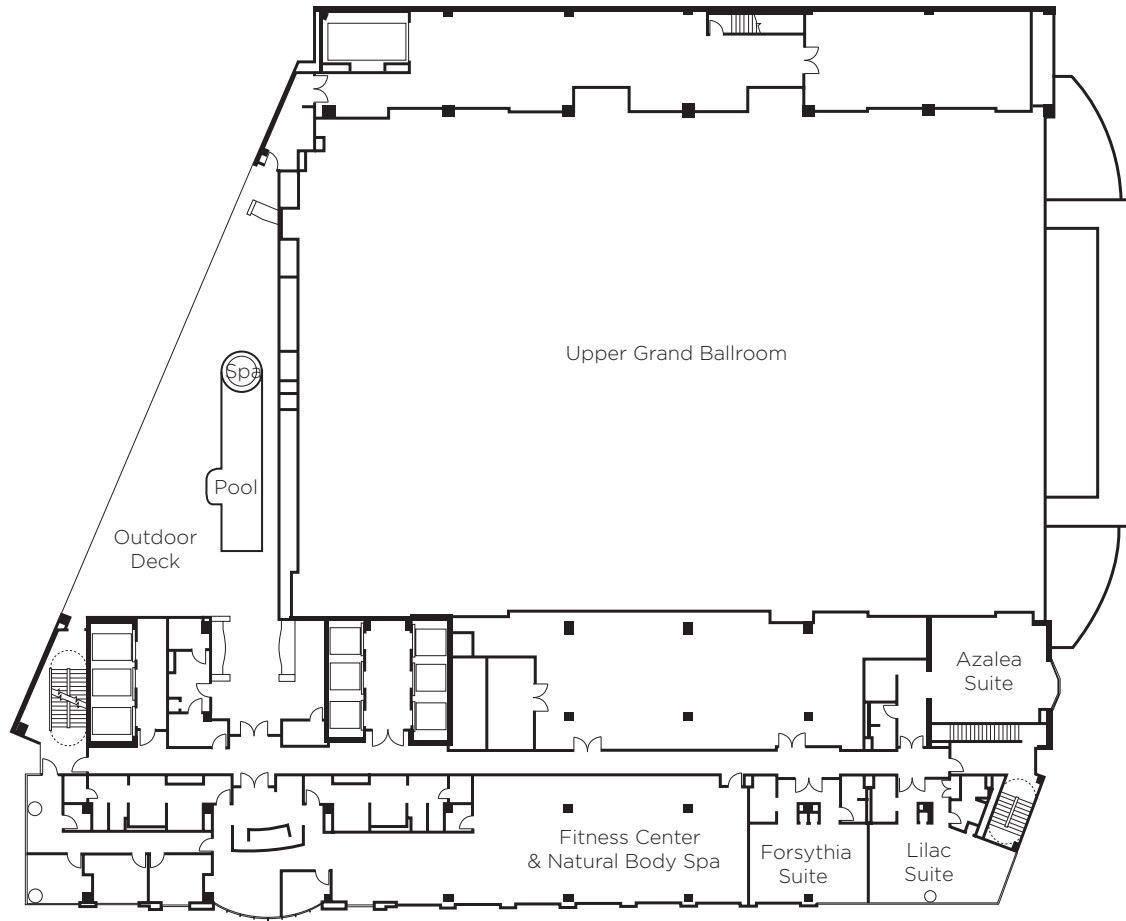

N6/Fitness Center/Pool Level Specifications

Room	Square Footage	Reception
Fitness Center & Spa	4,670	-
Pool & Deck	3,724	-
Forsythia Suite	856	30
Lilac Suite	818	30
Azalea Suite	768	30

Meeting room capacities are determined by use of the "Arranger & Comfort Calculator," a standardized meeting room capacity measurement system used by Meeting Professionals International.

