

ATLANTA

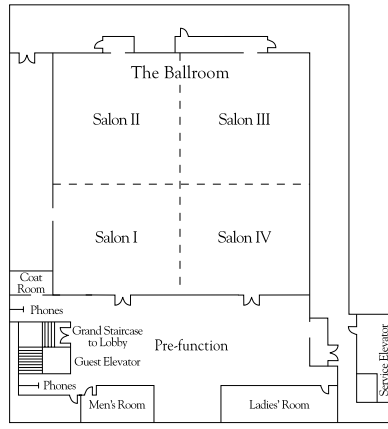

Lower Level

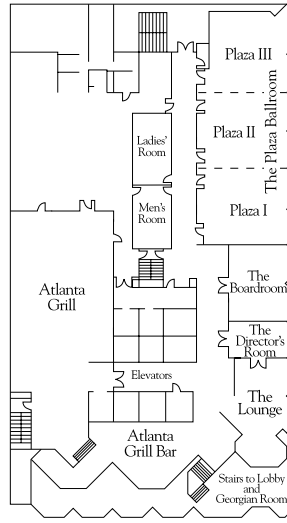

Second Floor

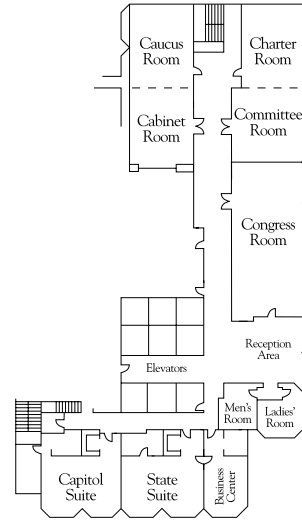

Third Floor

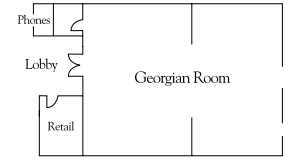

Lobby Level

MEETING SPACE	Square Feet	Square Meters	Dimensions		Ceiling Height		Reception	Banquet Rounds of 10	Theater Seating	Conference Seating	Classroom Seating	U-Shape Seating
			Feet	Meters	Feet	Meters						
The Ballroom	6,468	601	84x77	26x24	14	4	700	500	700	-	450	-
Salons I and II	3,234	300	84x38	26x12	14	4	250	210	350	50	225	83
Salons III and IV	3,234	300	84x38	26x12	14	4	250	210	350	50	225	83
Salons I, II, III or IV	1,617	150	42x38	13x12	14	4	125	90	150	30	72	30
Pre-function Area	1,800	167	56x36	17x11	-	-	250	-	-	-	-	-
The Plaza Ballroom	2,356	219	76x31	23x9	8	2	300	120	200	86	135	80
Plaza I	775	72	25x31	8x10	8	2	100	50	60	22	36	24
Plaza II	806	75	26x31	8x10	8	2	100	50	60	22	36	24
Plaza III	775	72	25x31	8x10	8	2	100	50	60	22	36	24
The Boardroom	510	47	23x22	7x7	11	3	-	-	-	12	-	-
The Director's Room	364	34	26x14	8x4	11	3	20	-	-	10	-	-
The Lounge	661	61	23x24	7x7	9	3	175	50	30	20	24	24
Capitol Suite	494	46	26x19	8x6	8	2	25	20	-	8	-	-
State Suite	494	46	26x19	8x6	8	2	25	20	-	8	-	-
Congress Room	1,250	116	50x25	15x17	9	3	125	80	100	39	66	36
Committee Room	529	49	23x23	7x7	9	3	40	40	50	20	27	18
Charter Room	546	51	26x21	8x6	8	2	40	40	50	20	27	18
Caucus Room	525	49	25x21	7x6	8	2	40	40	50	20	27	18
Cabinet Room	480	45	24x20	7x6	7	2	40	40	60	24	27	24
Georgian Room	1,496	139	34x44	10x13	12	4	150	108	-	-	204	-
Charter and Committee	1,075	100	49x44	15x13	-	-	80	80	100	40	54	36
Caucus and Cabinet	1,005	94	49x41	14x12	-	-	80	80	110	44	54	42

181 Peachtree Street • Atlanta, Georgia 30303 • USA

TEL 404-659-0400 FAX 404-688-0400

www.ritzcarlton.com/atlanta



THE RITZ-CARLTON®
ATLANTA

